

# Clip Buddy

Patent 10,072,685

## Clip holding device for fixtures

Lever Open

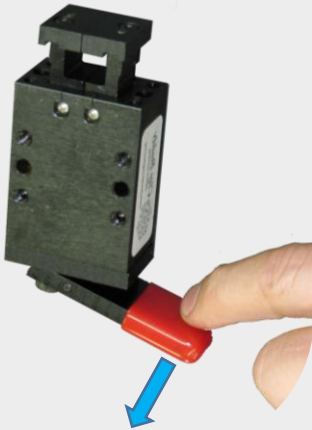

Lever Close

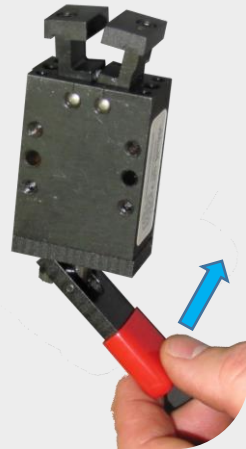

**Or**

Squeeze to Close



- Compact design
- Solid, snap-action closing
- Smooth, operator friendly motions
- Extensive Options:
  - 10 Jaw Options
  - 5 Mounting Brackets
  - 4 Manual Levers
  - Cable and Pneumatic Actuation Options

## Compare to conventional designs

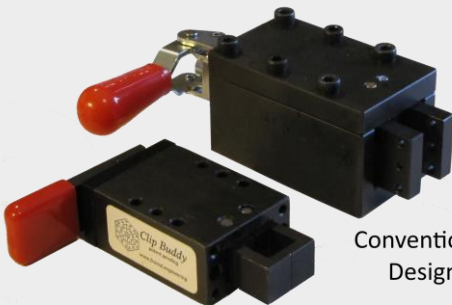

**Clip Buddy**

Conventional Design

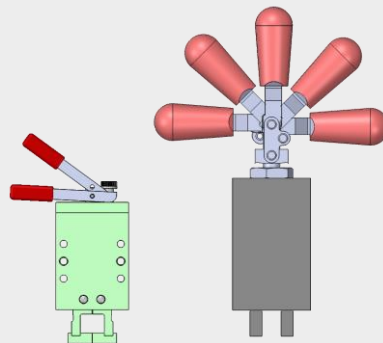

**Clip Buddy**

Conventional Design

- Much smaller footprint
- Less access space required for actuation
- Extensive mounting and actuation options

- Opening and closing motions are smooth and compact
- Operator-friendly and reliable cable actuation system (optional)

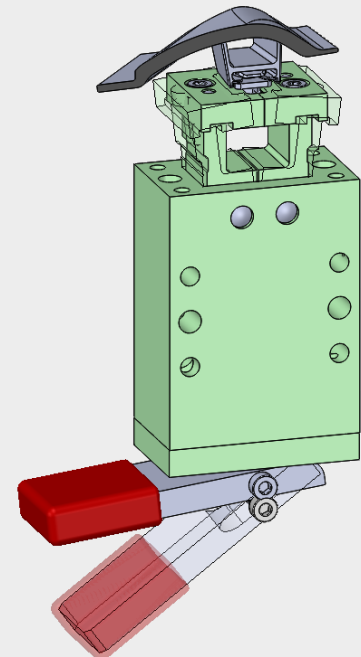

# ORDERING INFORMATION

# Clip Buddy

Patent 10,072,685

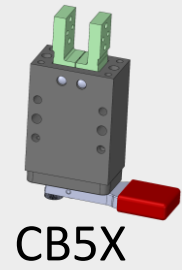
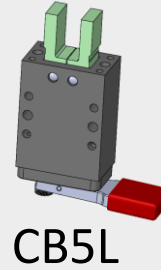
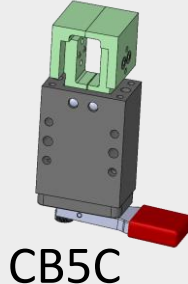
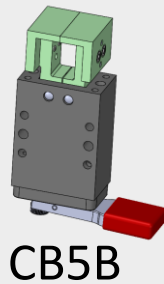
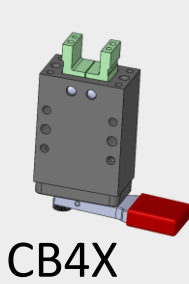
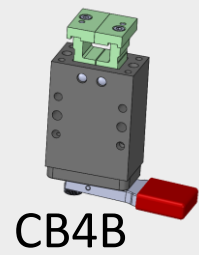
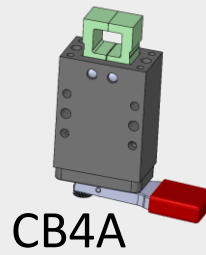
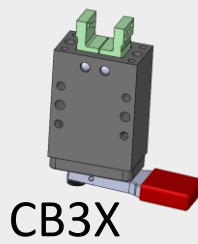
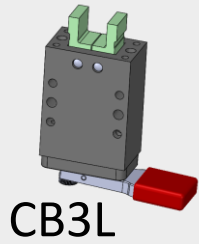
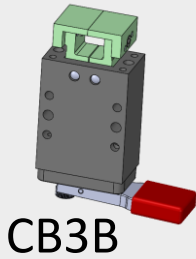

## Actuation Options

(short lever shown above is standard)

**CB4L90**  
90 degree lever

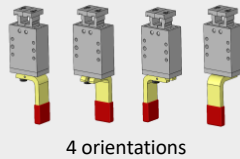

**CB4LG**  
Long Lever

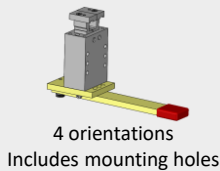

**CB4LS**  
Long Shaft  
(cut to length)

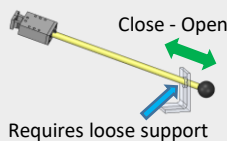

**CB4CBL**  
Cable Assembly  
2 Meter

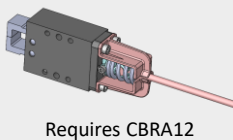

**CB4CYL**  
Pneumatic  
Cylinder

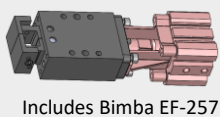

## Mounting Options

Standard  
Mounting  
(Included)

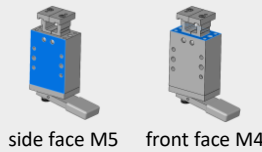

**CB4MA**  
Angle Bracket

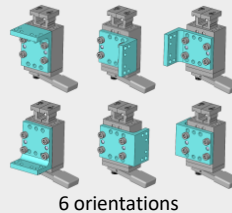

**CB4MF**  
Front Mount  
Plate - Centered

**CB4MFS**  
Front Mount  
Plate - Side

**CB4MRC**  
Rear Mount  
Plate - Centered

**CB4MRS**  
Rear Mount  
Plate - Side

*all optional mounting brackets have  
Ø5 dowel holes and M5 tapped holes*

## Accessories

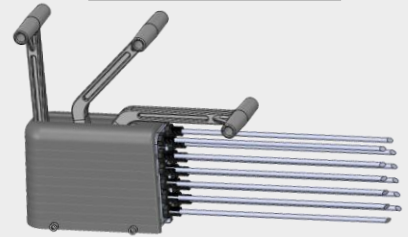

(For 1-12  
CB4CBL Units) **CBRA12**  
Remote Cable  
Actuator

*Smooth, operator-friendly actuation.  
Reliable operation, simple adjustment*

**CBPA6**  
(For 1-6  
CB4CYL Units)

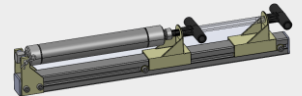

**CBPA10**  
(For 1-10  
CB4CYL Units)

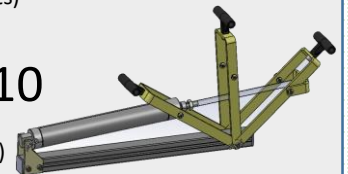

### Pneumatic Actuators

*Onboard actuation for  
CB4CYL/CB4CYLM-equipped units.  
No air hookup, no high pinch force.*

**CB4ST1**  
Stop Plate

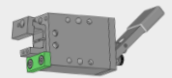

for single-side opening

